

Donation District No. 10.

Courses up French Creek

- 1st N 15 E 66 rods
- 2nd N 9 W 14 do.
- 3rd N 7 10 W 12 do.
- 4th N 14 W 72 do.
- 5 N 5 W 75 do.

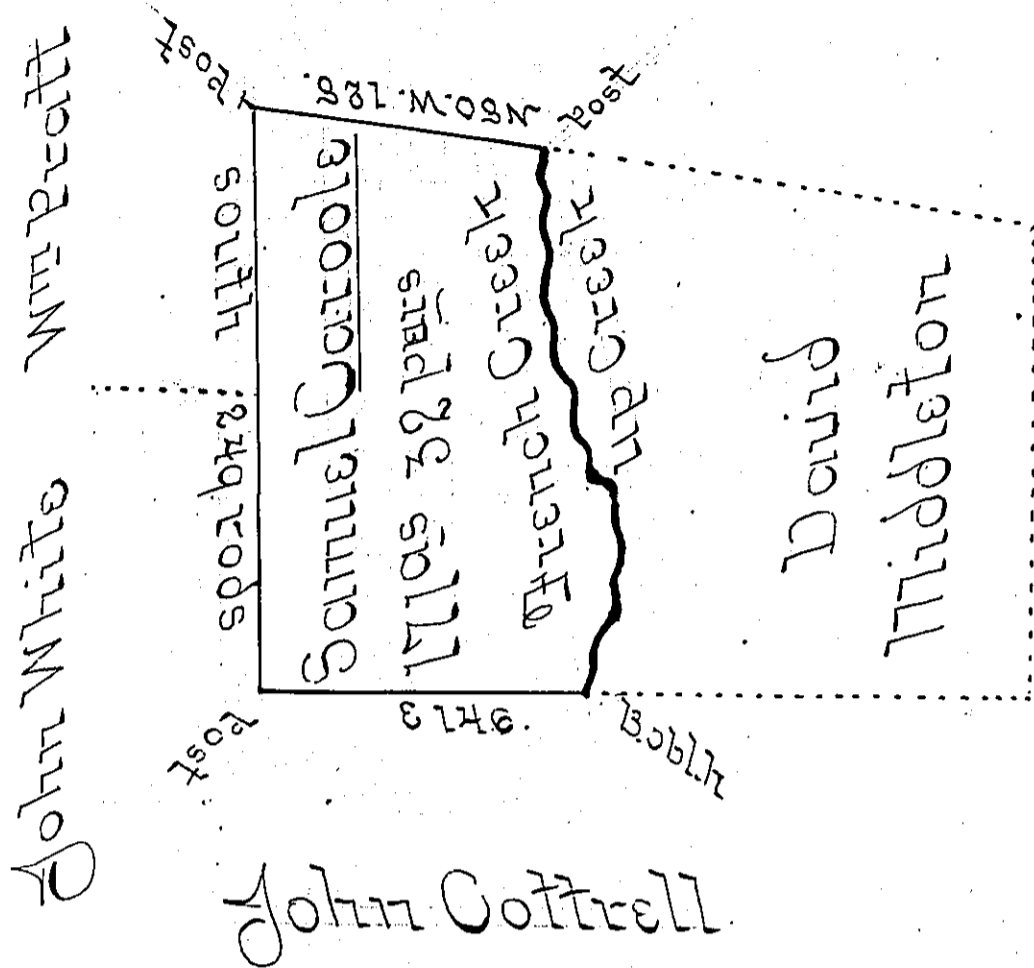

John White

John Cottrell

A Draught of Part of a Tract of Land lying on the Waters of French on the west side of said Creek in Washington Township Erie Co. Pa Surveyed the 2nd day of April 1840 for the Heirs of Samuel Carroll Decd by virtue of the actual Settlement residence and improvement of the said Samuel Carroll & containing 171 Acres 33 perches & Allowance &c.

To Jacob Sallade Sg.
Harrisburgh Pa

James Graham D.S.

IN TESTIMONY that the above is a copy of the original remaining on file in the Department of Internal Affairs of Pennsylvania, made conformably to an Act of Assembly approved the 16th day of February, 1833, I have hereunto set my Hand and caused the Seal of said Department to be affixed at Harrisburg, this first day of July 1902.-

James W. Latta
Secretary of Internal Affairs.